

40 FT
12.2 M

Digital X-Ray System



C37 DRP1417V
C37 DRP1717V

C37 - Healthcare

The power of the right equipment in the hands of a medical expert is critical to timely and accurate treatment. It is that pillar of strength that supports modern healthcare today and enables healthcare professionals take the right decisions.

Our ultimate vision is to create cutting edge products that offer comprehensive solutions to our customers.

KEY FEATURES

- **Wireless static flat panel detector**
- **Cassette-size**
- **Sync-shot exposure trigger**
- **GOS or CsI scintillation screen**
- **Easy to change cable and update firmware**
- **Battery recycling**

C37 Healthcare Private Limited

B 236/A, 6th Cross, 1st Stage, Peenya Industrial Estate, Bangalore - 560 058. INDIA.
+91-80-2839 8333 | info@c37.co.in | www.c37.co.in

Comprehensive Solutions

Cutting edge products



Digital X-Ray

This panel provides digital X ray imaging for diagnosis of disease, injury, or any applicable health problem. The image is obtained as the result of X ray passing through the human body and detected by . The panel is intended to be used in holder or bucky which is well insulated to panel. The holder or the bucky is well grounded.

Why C37?

- Over a decade of experience in the field of Medical Diagnostic Imaging Equipment
- Wide range of tools and test equipment
- Well-trained and dedicated team of professionals
- Global access for all GE spares for Medical Diagnostic Imaging Equipment
- Range of services to ensure smooth operations at all steps from procurement and installation of machines to maintenance

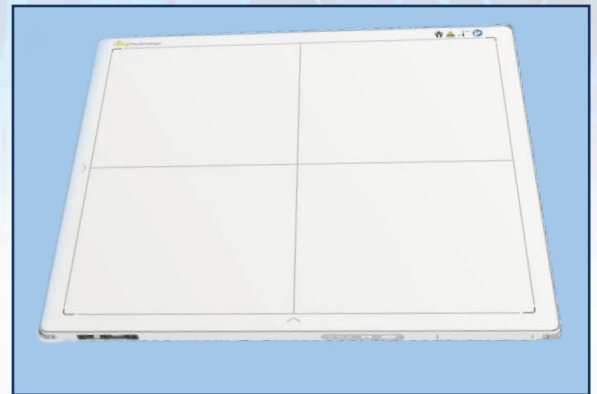

Characteristics

- Superior 14x17" wireless cassette size
- Flat Panel Detector
- Dual band (2.4GHz) wireless support with easy sharing
- 150um pixel pitch, with 16 bit ADC for more image details
- Stable iSync + Automatic Exposure Detection (AED)
- Long battery life and smart workflow
- Direct deposition CSI for better image quality with lower dose supports a fast workflow & is the optimal choice for both retrofit and new DR system solutions
- Weight - 3.3kgs
- Internal Storage of 200 full images

Instructions



DC & Ethernet Cable Input



DC & Medical Adapter Connector

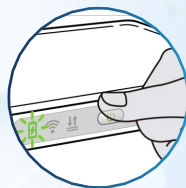

System Booting Button



A. DC Jack
B. Ethernet Interface



C. Detector Indicator
D. Power Button
E. Infrared Window

Our Expertise:

CT • PET • CT Nuclear Medicine • MRI
Cath Lab • AW Workstation • Mammography
C-Arm • Ultrasound • BMD